

# PAF 系列 Series

## 三相交流濾波電容器 Three Phase AC Filter

### 基本技術特點 GENERAL TECHNICAL CHARACTERISTICS

引用標準 Reference Standards	IEC 61071-60068	
絕緣介質 Dielectric	聚丙烯薄膜 Polypropylene film	
結構 Construction	乾式結構 Dry construction	
封裝 Coating	鋁外殼 Aluminum case	
端子 Leads	M8, M10 螺孔 Threaded insert M8 or M10	

### 技術規格 ELECTRICAL CHARACTERISTICS

工作溫度 Operating Temperature	-40 to +85°C (外殼 case)
電容量 Capacitance	3x30 to 3x500µF
額定電壓 Rated Voltage	400 to 850VAC
容差 Tolerance	±5% or ±10%
自感 Ls Self-inductance	<100nH
損耗因數 Dissipation Factor	≤2× 10 <sup>-3</sup> 在100Hz和25±5°C測定 ≤2× 10 <sup>-3</sup> measured at 100Hz and 25±5°C
預期壽命 Life Expectancy	在額定交流電壓和 70°C (熱點溫度)的條件下可達30,000小時 30,000 hours at Urms and 70°C (Hot-spot temperature)

### 測試 TEST METHODS AND PERFORMANCE

極間耐電壓 Voltage withstand between terminals	在2.15倍額定交流電壓Un下持續10秒 (25±5°C) 2.15Urms applied for 10 sec at 25±5°C
極殼之間耐電壓 Test Voltage Terminal to Case	3kVAC/50Hz 持續60秒 3kVAC/50Hz for 60 sec
自放電時間常數 Self discharge time constant	≥5,000 秒 (典型值), 電容器充電1分鐘後增加100VDC (25±5°C) ≥5,000 sec (typical value) after 1 minute of electrification at 100VDC (25±5°C)

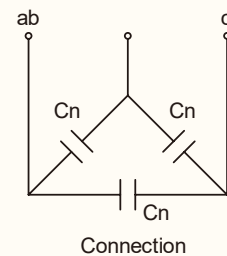
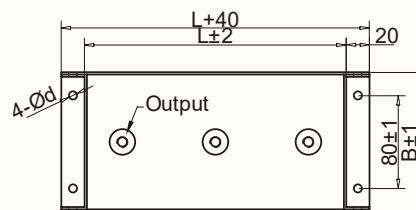
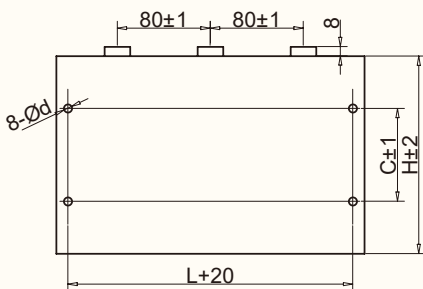

外殼箱代碼 Case Code	長度 L (mm)	寬度 B (mm)	高度 H (mm)	孔距 C (mm)	孔直徑 d (mm)	引出 Output	引出代碼 Output Code	力矩 Torque
A1T	225	120	170	80	7	M8 x 10	M8	8.5 N.m Max
A2C	225	120	235	100	7	M8 x 10	M8	8.5 N.m Max
B2C	295	120	235	100	9	M10 x 10	MK	12 N.m Max
C2C	365	120	235	120	9	M10 x 10	MK	12 N.m Max

規格若有任何變更將不予通知。如有產品安全或技術問題，請即與我司業務部或代理商聯繫。  
Specifications are subject to change without notice. For any concern on safety or technical aspects on the product, please contact our sales offices or agents immediately.

## 產品編碼和電性規格 PART NUMBER AND ELECTRICAL SPECIFICATIONS

產品編碼 Part Number	容量 Cap ( $\mu$ F)	等效 串聯 電阻 ESR@ 1.0 kHz ( $m\Omega$ )	紋波 電流 I <sub>rms</sub> @25°C @10kHz (A)	外殼箱 代碼 Case Code	熱阻 R <sub>th</sub> (°C/W)	重量 Weight (kg)
Urms 400VAC, Upeak 565V						
PAF607*2GA1TM8SA	3× 200	3× 0.95	3× 70	A1T	1.11	6.2
PAF907*2GA2CM8SA	3× 300	3× 0.88	3× 90	A2C	0.86	8.70
PAF128*2GB2CMKSA	3× 400	3× 0.83	3× 120	B2C	0.71	11.20
PAF158*2GC2CMKSA	3× 500	3× 0.80	3× 160	C2C	0.60	14.50
Urms 500VAC, Upeak 710V						
PAF367*2HA1TM8SA	3× 120	3× 1.01	3× 50	A1T	1.11	6.20
PAF547*2HA2CM8SA	3× 180	3× 0.92	3× 70	A2C	0.86	8.70
PAF727*2HB2CMKSA	3× 240	3× 0.86	3× 100	B2C	0.71	11.20
PAF907*2HC2CMKSA	3× 300	3× 0.83	3× 120	C2C	0.60	14.50
Urms 550VAC, Upeak 780V						
PAF277*25A1TM8SA	3× 90	3× 1.86	3× 30	A1T	1.11	6.20
PAF4K7*25A2CM8SA	3× 135	3× 1.49	3× 60	A2C	0.86	8.70
PAF5E7*25B2CMKSA	3× 185	3× 1.28	3× 80	B2C	0.71	11.20
PAF6H7*25C2CMKSA	3× 225	3× 1.19	3× 100	C2C	0.60	14.50
Urms 690VAC, Upeak 975V						
PAF157*27A1TM8SA	3× 50	3× 2.03	3× 40	A1T	1.11	6.20
PAF2B7*27A2CM8SA	3× 75	3× 1.64	3× 60	A2C	0.86	8.70
PAF307*27B2CMKSA	3× 100	3× 1.39	3× 80	B2C	0.71	11.20
PAF2G7*27C2CMKSA	3× 125	3× 1.28	3× 100	C2C	0.60	14.50
Urms 850VAC, Upeak 1200V						
PAF906*2RA1TM8SA	3× 30	3× 2.36	3× 30	A1T	1.11	6.20
PAF1C7*2RA2CM8SA	3× 45	3× 1.85	3× 50	A2C	0.86	8.70
PAF1*7*2RB2CMKSA	3× 65	3× 1.50	3× 70	B2C	0.71	11.20
PAF247*2RC2CMKSA	3× 80	3× 1.38	3× 80	C2C	0.60	14.50

備註： 產品編碼的第7位的“\*”是代表可選容差為J= ±5%或K= ±10%。

Remark : The “\*” in 7th digit is used for the capacitance tolerance, J= ±5% or K= ±10%.

規格若有任何變更將不予通知。如有產品安全或技術問題，請即與我司業務部或代理商聯繫。  
Specifications are subject to change without notice. For any concern on safety or technical aspects on the product, please contact our sales offices or agents immediately.