

# PDE 系列 Series

直流鏈支撐電容器 DC-Link

## 基本技術特點 GENERAL TECHNICAL CHARACTERISTICS

引用標準 Reference Standards	IEC 61071-60068	
絕緣介質 Dielectric	聚丙烯薄膜 Polypropylene film	
結構 Construction	乾式結構 Dry construction	
封裝 Coating	鋁外殼 Aluminum case	
端子 Leads	M6螺孔, 亦可選螺柱 Threaded insert M6, bolt available	

## 技術規格 ELECTRICAL CHARACTERISTICS

工作溫度 Operating Temperature	-40 to +85°C (外殼 case)
電容量 Capacitance	80 to 1000µF
額定電壓 Rated Voltage	800 to 2400VDC
容差 Tolerance	±5% or ±10%
損耗因數 Dissipation Factor	≤2× 10 <sup>-3</sup> 在100Hz和25±5°C測定 ≤2× 10 <sup>-3</sup> measured at 100Hz and 25±5°C
預期壽命 Life Expectancy	在額定電壓和 70°C (熱點溫度)的條件下可達100,000小時 100,000 hours at Un and 70°C (Hot-spot temperature)

## 測試 TEST METHODS AND PERFORMANCE

極間耐電壓 Voltage withstand between terminals	在1.5倍額定電壓Un下持續10秒 (25±5°C) 1.5Un (DC) applied for 10 sec at 25±5°C
極殼之間耐電壓 Test Voltage Terminal to Case	(1.5× Un+1000)VAC或最少3kVAC持續60秒 (1.5× Un+1000)VAC, Min. 3kVAC for 60 sec
自放電時間常數 Self discharge time constant	≥10,000 秒, 電容器充電1分鐘後增加100VDC (25±5°C) ≥10,000 sec after 1 minute of electrification at 100VDC (25±5°C)

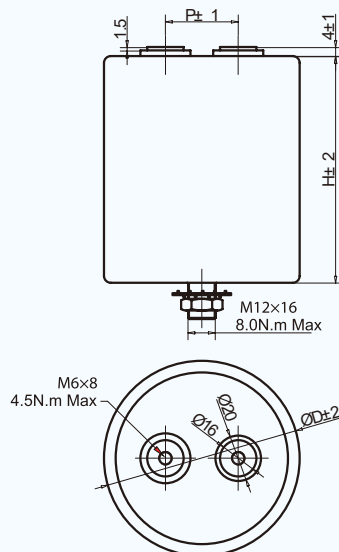

規格若有任何變更將不予通知。如有產品安全或技術問題，請即與我司業務部或代理商聯繫。  
Specifications are subject to change without notice. For any concern on safety or technical aspects on the product, please contact our sales offices or agents immediately.

## 產品編碼和電性規格 PART NUMBER AND ELECTRICAL SPECIFICATIONS

產品編碼 Part Number	容量 Cap ( $\mu$ F)	直徑 D (mm)	高度 H (mm)	極距 P (mm)	紋波 電流 I <sub>rms</sub> @25°C @10kHz (A)	等效 串聯 電阻 ESR@ 1.0kHz (m $\Omega$ )	熱阻 R <sub>th</sub> (°C/W)	重量 Weight (kg)
<b>Un 800VDC, Us 1200V, Ur 200V</b>								
PDE437*2KU1NMFSA	430	76	120	32	40	4.3	3.9	0.65
PDE557*2KV1NMFSA	550	86	120	32	46	3.7	3.5	0.85
PDE807*2KU2BMFSA	800	76	225	32	67	2.9	2.0	1.25
PDE108*2KV2BMFSA	1000	86	225	32	76	2.6	1.8	1.50
<b>Un 1000VDC, Us 1500V, Ur 250V</b>								
PDE2G7*3AU1NMFSA	275	76	120	32	37	5.0	3.9	0.65
PDE357*3AV1NMFSA	350	86	120	32	53	5.2	3.5	0.85
PDE507*3AU2BMFSA	500	76	225	32	63	3.3	2.0	1.25
PDE687*3AV2BMFSA	680	86	225	32	73	2.8	1.8	1.50
<b>Un 1200VDC, Us 1800V, Ur 300V</b>								
PDE207*3OU1NMFSA	200	76	120	32	35	5.5	3.9	0.65
PDE257*3OV1NMFSA	250	86	120	32	41	4.7	3.5	0.85
PDE377*3OU2BMFSA	370	76	225	32	61	3.6	2.0	1.25
PDE477*3OV2BMFSA	470	86	225	32	69	3.1	1.8	1.50
<b>Un 1400VDC, Us 2100V, Ur 330V</b>								
PDE147*3FU1NMFSA	140	76	120	32	33	6.5	3.9	0.65
PDE187*3FV1NMFSA	180	86	120	32	38	5.3	3.5	0.85
PDE277*3FU2BMFSA	270	76	225	32	58	4.0	2.0	1.25
PDE357*3FV2BMFSA	350	86	225	32	66	3.4	1.8	1.50
<b>Un 1600VDC, Us 2400V, Ur 350V</b>								
PDE107*3CU1NMFSA	100	76	120	32	30	7.7	3.9	0.65
PDE147*3CV1NMFSA	140	86	120	32	36	5.9	3.5	0.85
PDE207*3CU2BMFSA	200	76	225	32	54	4.5	2.0	1.25
PDE277*3CV2BMFSA	270	86	225	32	64	3.7	1.8	1.50
<b>Un 1800VDC, Us 2700V, Ur 400V</b>								
PDE806*3PU1NMFSA	80	76	120	32	29	8.4	3.9	0.65
PDE117*3PV1NMFSA	110	86	120	32	35	6.4	3.5	0.85
PDE167*3PU2BMFSA	160	76	225	32	52	4.8	2.0	1.25
PDE207*3PV2BMFSA	200	86	225	32	60	4.1	1.8	1.50
<b>Un 2000VDC, Us 3000V, Ur 450V</b>								
PDE137*3DU2BMFSA	130	76	225	32	36	10.4	2.0	1.25
PDE177*3DV2BMFSA	170	86	225	32	42	8.6	1.8	1.50
<b>Un 2400VDC, Us 3600V, Ur 500V</b>								
PDE906*34U2BMFSA	90	76	225	32	33	12.0	2.0	1.25
PDE127*34V2BMFSA	120	86	225	32	39	9.7	1.8	1.50

備註： 產品編碼的第7位的“\*”是代表可選容差為J=  $\pm$ 5% 或 K=  $\pm$ 10%。

Remark : The “\*” in 7th digit is used for the capacitance tolerance, J=  $\pm$ 5% or K=  $\pm$ 10%.

規格若有任何變更將不予通知。如有產品安全或技術問題，請即與我司業務部或代理商聯繫。  
Specifications are subject to change without notice. For any concern on safety or technical aspects on the product, please contact our sales offices or agents immediately.

# PDP 系列 Series

## 直流鏈支撐電容器 DC-Link

### 基本技術特點 GENERAL TECHNICAL CHARACTERISTICS

引用標準 Reference Standards	IEC 61071-60068, UL810 已認證 IEC 61071-60068, UL810 Approved
絕緣介質 Dielectric	聚丙烯薄膜 Polypropylene film
結構 Construction	乾式結構 Dry construction
封裝 Coating	鋁外殼 Aluminum case
端子 Leads	M6螺孔, 亦可選螺柱 Threaded insert M6, bolt available



### 技術規格 ELECTRICAL CHARACTERISTICS

工作溫度 Operating Temperature	-40 to +85°C (外殼 case)
電容量 Capacitance	75 to 2750µF
額定電壓 Rated Voltage	600 to 2500VDC
容差 Tolerance	±5% or ±10%
損耗因數 Dissipation Factor	≤3× 10 <sup>-3</sup> 在100Hz和25±5°C測定 ≤3× 10 <sup>-3</sup> measured at 100Hz and 25±5°C
預期壽命 Life Expectancy	在額定電壓和 70°C (熱點溫度)的條件下可達100,000小時 100,000 hours at Un and 70°C (Hot-spot temperature)

### 測試 TEST METHODS AND PERFORMANCE

極間耐電壓 Voltage withstand between terminals	在1.5倍額定電壓Un下持續10秒 (25±5°C) 1.5Un (DC) applied for 10 sec at 25±5°C
極殼之間耐電壓 Test Voltage Terminal to Case	(1.5× Un+1000)VAC或最少3kVAC持續60秒 (1.5× Un+1000)VAC, Min. 3kVAC for 60 sec
自放電時間常數 Self discharge time constant	≥10,000 秒, 電容器充電1分鐘後增加100VDC (25±5°C) ≥10,000 sec after 1 minute of electrification at 100VDC (25±5°C)

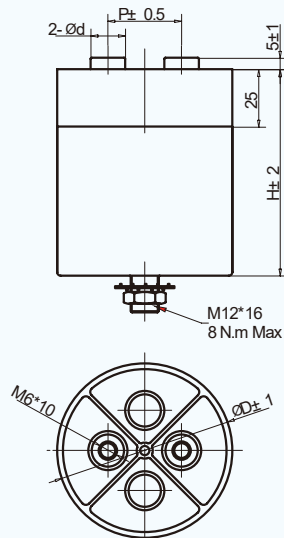

D=76, 86mm	D=116mm	D=136mm
d=14mm	d=14mm	d=16mm
P=32mm	P=50mm	P=50mm

規格若有任何變更將不予通知。如有產品安全或技術問題，請即與我司業務部或代理商聯繫。  
Specifications are subject to change without notice. For any concern on safety or technical aspects on the product, please contact our sales offices or agents immediately.

## 產品編碼和電性規格 PART NUMBER AND ELECTRICAL SPECIFICATIONS

產品編碼 Part Number	容量 Cap ( $\mu$ F)	直徑 D (mm)	高度 H (mm)	極距 P (mm)	紋波 電流 I <sub>rms</sub> @25°C @10kHz (A)	等效 串聯 電阻 ESR@ 1.0kHz (m $\Omega$ )	自感 L <sub>s</sub> (nH)	熱阻 R <sub>th</sub> (°C/W)	儲能 W <sub>n</sub> (Ws)	重量 Weight (kg)
Un 600VDC, Us 900V, Ur 150V										
PDP657*26V1BM6SA	650	86	125	32	73	1.0	40	2.9	117	1.00
Un 900VDC, Us 1350V, Ur 200V										
PDP377*29U1BM6SA	370	76	125	3.3	60	1.2	40	3.7	150	0.75
PDP397*29U1NM6SA	390	76	120	1.6	33	3.7	60	3.9	158	0.70
PDP457*29U1DM6SA	450	76	145	3.2	61	1.3	45	3.2	182	0.85
PDP497*29V1BM6SA	490	86	125	4.4	71	0.9	40	3.3	198	0.95
PDP527*29V1NM6SA	520	86	120	2.1	40	2.9	60	3.5	211	0.90
PDP577*29U1GM6SA	570	76	175	3.4	61	1.6	50	2.7	231	1.10
PDP607*29V1DM6SA	600	86	145	4.2	72	1.1	45	2.9	243	1.10
PDP757*29V1GM6SA	750	86	175	4.5	73	1.3	50	2.4	304	1.30
PDP787*29U2BM6SA	780	76	225	3.1	63	2.0	60	2.0	316	1.30
PDP108*29A1BM6SA	1000	116	125	4.0	53	1.6	60	2.9	405	1.70
PDP1K8*29V2BM6SA	1050	86	225	4.2	76	1.5	60	1.8	425	1.60
PDP118*29A1RM6SA	1100	116	150	7.7	88	0.7	45	2.5	446	2.10
PDP1D8*29A1UM6SA	1450	116	180	8.7	90	0.7	50	2.1	587	2.40
PDP208*29A2PM6SA	2000	116	230	8.0	92	0.9	60	1.7	810	3.00
PDP2G8*29C2PMFSA	2750	136	230	11.0	99	0.7	60	1.5	1114	4.10
Un 1100VDC, Us 1650V, Ur 250V										
PDP257*31U1NM6SA	250	76	120	1.5	30	4.6	60	3.9	151	0.70
PDP337*31V1NM6SA	330	86	120	2.0	36	3.6	60	3.5	200	0.90
PDP377*31V1PM6SA	370	86	130	1.9	36	3.8	60	3.2	224	0.95
PDP407*31V1DM6SA	400	86	145	4.0	67	1.2	45	2.9	242	1.10
PDP427*31V1PM6SA	420	86	136	2.5	45	2.0	60	3.2	254	0.80
PDP427*31V1EM6SA	420	86	155	4.2	69	1.2	45	2.7	254	1.20
PDP507*31V1GM6SA	500	86	175	4.0	67	1.5	50	2.4	303	1.30
PDP657*31A1BM6SA	650	116	125	3.9	49	1.9	60	2.9	393	1.70
PDP687*31V2BM6SA	680	86	225	4.1	69	1.8	60	1.8	411	1.60
PDP737*31A1RM6SA	730	116	150	7.3	82	0.8	45	2.5	442	2.10
PDP907*31C1BM6SA	900	136	125	5.4	54	1.4	60	2.5	545	2.30
PDP927*31A1UM6SA	920	116	180	7.4	82	0.9	50	2.1	557	2.40
PDP1B8*31A2PM6SA	1250	116	230	7.5	84	1.1	60	1.7	756	3.00
PDP178*31C2PM6SA	1700	136	230	10.2	90	0.9	60	1.5	1029	4.20
PDP198*31C2SM6SA	1900	136	260	15.2	120	0.5	50	1.3	1150	4.70
PDP2E8*31C3CM6SA	2550	136	335	15.3	120	0.6	60	1.0	1543	6.00
Un 1300VDC, Us 1950V, Ur 300V										
PDP177*3BU1NM6SA	170	76	120	1.4	27	5.6	60	3.9	144	0.70
PDP237*3BV1NM6SA	230	86	120	1.8	33	4.2	60	3.5	194	0.90
PDP337*3BV1GM6SA	330	86	175	3.3	61	1.8	50	2.4	279	1.30
PDP457*3BA1BM6SA	450	116	125	3.6	45	2.3	60	2.9	380	1.70
PDP477*3BV2BM6SA	470	86	225	3.8	64	2.2	60	1.8	397	1.60
PDP507*3BA1RM6SA	500	116	150	6.5	76	0.9	45	2.5	423	2.10
PDP637*3BC1BM6SA	630	136	125	5.0	50	1.7	60	2.5	532	2.30
PDP647*3BA1UM6SA	640	116	180	6.4	77	1.0	50	2.1	541	2.40
PDP857*3BA2PM6SA	850	116	230	6.8	77	1.3	60	1.7	718	3.00
PDP907*3BC1UM6SA	900	136	180	9.0	84	0.8	50	1.9	761	3.30
PDP128*3BC2PM6SA	1200	136	230	9.6	84	1.0	60	1.5	1014	4.10
PDP1C8*3BC2SM6SA	1350	136	260	13.5	114	0.6	50	1.3	1141	4.60
PDP188*3BC3CM6SA	1800	136	335	14.4	119	0.7	60	1.0	1521	6.00

規格若有任何變更將不予通知。如有產品安全或技術問題，請即與我司業務部或代理商聯繫。  
Specifications are subject to change without notice. For any concern on safety or technical aspects on the product, please contact our sales offices or agents immediately.

## 產品編碼和電性規格 PART NUMBER AND ELECTRICAL SPECIFICATIONS

產品編碼 Part Number	容量 Cap ( $\mu$ F)	直徑 D (mm)	高度 H (mm)	極距 P (mm)	紋波 電流 I <sub>rms</sub> @25°C @10kHz (A)	等效 串聯 電阻 ESR@ 1.0kHz (m $\Omega$ )	自感 L <sub>s</sub> (nH)	熱阻 R <sub>th</sub> (°C/W)	儲能 W <sub>n</sub> (Ws)	重量 Weight (kg)
Un 1900VDC, Us 2850V, Ur 500V										
PDP756*39U1NM6SA	75	76	120	1.1	22	8.4	60	3.9	135	0.70
PDP107*39V1NM6SA	100	86	120	1.4	27	6.3	60	3.5	181	0.90
PDP157*39V1GM6SA	150	86	175	2.9	51	2.6	50	2.4	271	1.30
PDP197*39A1BM6SA	190	116	125	2.7	36	3.4	60	2.9	343	1.70
PDP207*39V2BM6SA	200	86	225	2.8	52	3.3	60	1.8	361	1.70
PDP227*39A1RM6SA	220	116	150	5.5	65	1.2	45	2.5	397	2.10
PDP2G7*39C1BM6SA	275	136	125	3.9	41	2.4	60	2.5	496	2.30
PDP287*39A1UM6SA	280	116	180	5.3	64	1.5	50	2.1	505	2.40
PDP387*39A2PM6SA	380	116	230	5.3	65	1.8	60	1.7	686	3.00
PDP407*39C1UM6SA	400	136	180	7.6	71	1.1	50	1.9	722	3.30
PDP547*39C2PM6SA	540	136	230	7.6	72	1.3	60	1.5	975	4.10
PDP607*39C2SM6SA	600	136	260	11.4	99	0.8	50	1.3	1083	4.60
PDP807*39C3CM6SA	800	136	335	11.2	102	1.0	60	1.0	1444	6.00
Un 2500VDC, Us 3750V, Ur 600V										
PDP956*3EA1PM6SA	95	116	130	1.5	43	2.5	40	2.8	297	1.80
PDP137*3EC1PM6SA	130	136	130	2.1	47	1.9	40	2.4	406	2.50
PDP207*3EA2PM6SA	200	116	230	1.6	42	4.4	60	1.7	625	3.00

備註： 產品編碼的第7位的“\*”是代表可選容差為J=  $\pm$ 5% 或 K=  $\pm$ 10%。

Remark : The “\*” in 7th digit is used for the capacitance tolerance, J=  $\pm$ 5% or K=  $\pm$ 10%.

規格若有任何變更將不予通知。如有產品安全或技術問題，請即與我司業務部或代理商聯繫。  
Specifications are subject to change without notice. For any concern on safety or technical aspects on the product, please contact our sales offices or agents immediately.

# PDF 系列 Series

## 大紋波電流的直流支撐電容器 High Current DC-Link

### 基本技術特點 GENERAL TECHNICAL CHARACTERISTICS

引用標準 Reference Standards	IEC 61071-60068
絕緣介質 Dielectric	聚丙烯薄膜 Polypropylene film
結構 Construction	乾式結構 Dry construction
封裝 Coating	UL94V-0 阻燃防火聚酯塑膠外殼, 環氧樹脂灌封 Polyester can, UL94V-0 resin end fill
端子 Leads	螺孔或螺柱 Threaded insert or bolt



### 技術規格 ELECTRICAL CHARACTERISTICS

工作溫度 Operating Temperature	-40 to +85°C (外殼 case)
電容量 Capacitance	6.8 to 220µF
額定電壓 Rated Voltage	600 to 2200VDC
容差 Tolerance	±5% or ±10%
損耗因數 Dissipation Factor	≤2× 10 <sup>-3</sup> 在100Hz和25±5°C測定 ≤2× 10 <sup>-3</sup> measured at 100Hz and 25±5°C
預期壽命 Life Expectancy	在額定電壓和 70°C (熱點溫度) 的條件下可達100,000小時 100,000 hours at Un and 70°C (Hot-spot temperature)

### 測試 TEST METHODS AND PERFORMANCE

極間耐電壓 Voltage withstand between terminals	在1.5倍額定電壓Un下持續10秒 (25±5°C) 1.5Un (DC) applied for 10 sec at 25±5°C
極殼之間耐電壓 Test Voltage Terminal to Case	(1.5× Un+1000)VAC或最少3kVAC持續60秒 (1.5× Un+1000)VAC, Min. 3kVAC for 60 sec
自放電時間常數 Self discharge time constant	≥5,000 秒, 電容器充電1分鐘後增加100VDC (25±5°C) ≥5,000 sec after 1 minute of electrification at 100VDC (25±5°C)

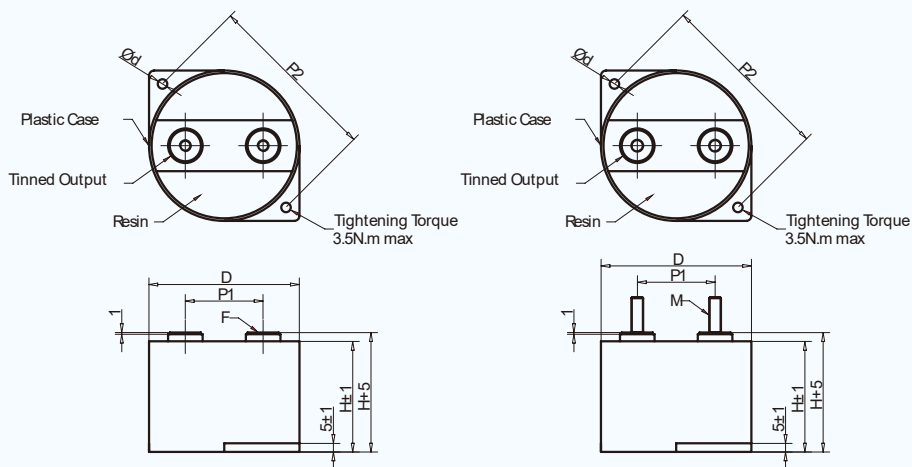

D	端子 Leads				P1	P2	d
(mm)	M	力矩 Torque	F	力矩 Torque	(mm)	(mm)	(mm)
87	M8 x 20	8.5 N.m Max	M6 x 8	4.5 N.m Max	45±1	101	5.5

規格若有任何變更將不予通知。如有產品安全或技術問題, 請即與我司業務部或代理商聯繫。  
Specifications are subject to change without notice. For any concern on safety or technical aspects on the product, please contact our sales offices or agents immediately.

## 產品編碼和電性規格 PART NUMBER AND ELECTRICAL SPECIFICATIONS

產品編碼 Part Number	容量 Cap ( $\mu$ F)	直徑 D (mm)	高度 H (mm)	最大 自感 Ls max. (nH)	電壓 上升 速率 du/dt (V/ $\mu$ s)	紋波 電流 I <sub>rms</sub> @25°C @10kHz (A)	等效 串聯 電阻 ESR@ 1.0kHz (m $\Omega$ )	熱阻 R <sub>th</sub> (°C/W)
Un 600VDC, Us 960V, Ur 175V								
PDF107*26W41M8SA	100	87	41	25	40	80	0.8	6.8
PDF157*26W51M8SA	150	87	51	32	27	80	0.9	5.9
PDF227*26W65M8SA	220	87	65	40	18	75	1.1	5.0
Un 700VDC, Us 1050V, Ur 200V								
PDF107*2SW41M8SA	100	87	41	25	48	90	0.6	6.8
PDF157*2SW51M8SA	150	87	51	32	32	90	0.7	5.9
PDF227*2SW65M8SA	220	87	65	40	21	85	0.9	5.0
Un 800VDC, Us 1280V, Ur 225V								
PDF686*2KW41M8SA	68	87	41	25	56	75	0.9	6.8
PDF107*2KW51M8SA	100	87	51	32	37	75	1.0	5.9
PDF147*2KW65M8SA	140	87	65	40	25	70	1.3	5.0
Un 900VDC, Us 1350V, Ur 250V								
PDF686*29W41M8SA	68	87	41	25	56	80	0.8	6.8
PDF107*29W51M8SA	100	87	51	32	37	80	0.9	5.9
PDF147*29W65M8SA	140	87	65	40	25	75	1.2	5.0
Un 1000VDC, Us 1600V, Ur 275V								
PDF476*3AW41M8SA	47	87	41	25	73	70	1.0	6.8
PDF686*3AW51M8SA	68	87	51	32	49	70	1.2	5.9
PDF107*3AW65M8SA	100	87	65	40	33	65	1.5	5.0
Un 1100VDC, Us 1650V, Ur 300V								
PDF476*31W41M8SA	47	87	41	25	73	75	0.9	6.8
PDF686*31W51M8SA	68	87	51	32	49	75	1.1	5.9
PDF107*31W65M8SA	100	87	65	40	33	70	1.4	5.0
Un 1200VDC, Us 1920V, Ur 325V								
PDF256*3OW41M8SA	25	87	41	25	90	60	1.2	6.8
PDF356*3OW51M8SA	35	87	51	32	70	60	1.5	5.9
PDF506*3OW65M8SA	50	87	65	40	50	55	2.0	5.0
Un 1500VDC, Us 2400V, Ur 350V								
PDF186*3ZW41M8SA	18	87	41	25	113	55	1.2	6.8
PDF256*3ZW51M8SA	25	87	51	32	85	55	1.7	5.9
PDF356*3ZW65M8SA	35	87	65	40	60	50	2.2	5.0
Un 1800VDC, Us 2880V, Ur 400V								
PDF106*3PW41M8SA	10	87	41	25	175	50	1.5	6.8
PDF156*3PW51M8SA	15	87	51	32	120	50	2.0	5.9
PDF226*3PW65M8SA	22	87	65	40	80	45	2.5	5.0
Un 2200VDC, Us 3520V, Ur 450V								
PDF685*3NW41M8SA	6.8	87	41	25	200	50	1.7	6.8
PDF106*3NW51M8SA	10	87	51	32	150	50	2.3	5.9
PDF156*3NW65M8SA	15	87	65	40	100	45	2.9	5.0

備註： 產品編碼的第7位的“\*”是代表可選容差為J=  $\pm$ 5% 或 K=  $\pm$ 10%。  
產品編碼的第13及14位的“\*\*”是代表成型MH或MF類型。

Remark : The “\*” in 7th digit is used for the capacitance tolerance, J=  $\pm$ 5% or K=  $\pm$ 10% .  
The “\*\*” in 13th and 14th digits are used for lead type, MH or MF.

規格若有任何變更將不予通知。如有產品安全或技術問題，請即與我司業務部或代理商聯繫。  
Specifications are subject to change without notice. For any concern on safety or technical aspects on the product,  
please contact our sales offices or agents immediately.

# PDB 系列 Series

## 直流鏈支撐電容器 DC-Link

### 基本技術特點 GENERAL TECHNICAL CHARACTERISTICS

引用標準 Reference Standards	IEC 61071-60068
絕緣介質 Dielectric	聚丙烯薄膜 Polypropylene film
結構 Construction	乾式結構 Dry construction
封裝 Coating	UL94V-0 阻燃防火聚酯塑膠外殼, 環氧樹脂灌封 Polyester can, UL94V-0 resin end fill
端子 Leads	鍍錫銅線 Tinned copper wire



### 技術規格 ELECTRICAL CHARACTERISTICS

工作溫度 Operating Temperature	-40 to +85°C (外殼 case)
電容量 Capacitance	6 to 80μF
額定電壓 Rated Voltage	500 to 1100VDC
容差 Tolerance	±5% or ±10%
損耗因數 Dissipation Factor	≤1×10 <sup>-3</sup> 在100Hz和25±5°C測定 ≤1×10 <sup>-3</sup> measured at 100Hz and 25±5°C
預期壽命 Life Expectancy	在額定電壓和 70°C (熱點溫度) 的條件下可達100,000小時 100,000 hours at Un and 70°C (Hot-spot temperature)

### 測試 TEST METHODS AND PERFORMANCE

極間耐電壓 Voltage withstand between terminals	在1.5倍額定電壓Un下持續10秒 (25±5°C) 1.5Un (DC) applied for 10 sec at 25±5°C
極殼之間耐電壓 Test Voltage Terminal to Case	3kVAC/50Hz 持續60秒 3kVAC/50Hz for 60 sec
自放電時間常數 Self discharge time constant	≥5,000 秒 (典型值), 電容器充電1分鐘後增加100VDC (25±5°C) ≥5,000 sec (typical value), after 1 minute of electrification at 100VDC (25±5°C)

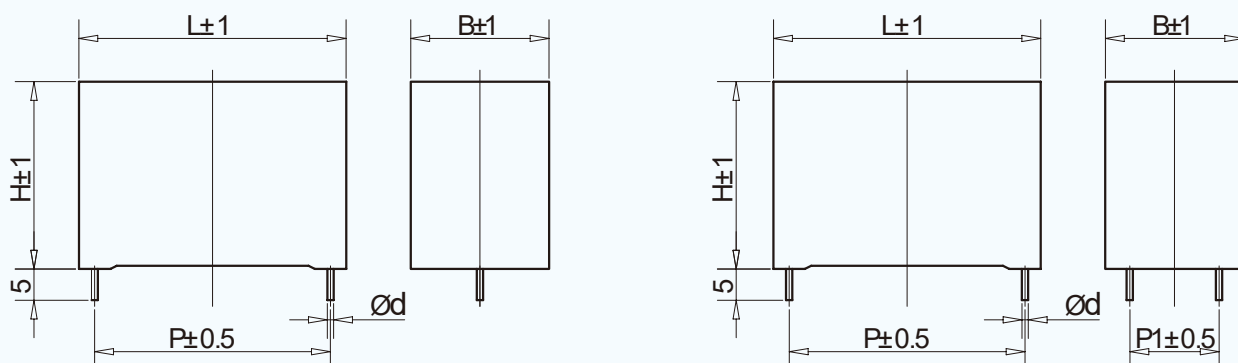

規格若有任何變更將不予通知。如有產品安全或技術問題，請即與我司業務部或代理商聯繫。  
Specifications are subject to change without notice. For any concern on safety or technical aspects on the product, please contact our sales offices or agents immediately.

## 產品編碼和電性規格 PART NUMBER AND ELECTRICAL SPECIFICATIONS

產品編碼 Part Number	容量 Cap ( $\mu$ F)	尺寸 Dimension (mm)						電壓 上升 速率 du/dt (V/ $\mu$ s)	紋波 電流 I <sub>rms</sub> @25°C @10kHz (A)	等效 串聯 電阻 ESR@ 1.0kHz (m $\Omega$ )
		長度 L	寬度 B	高度 H	極距 P	引腳 距離 P1	引線 直徑 d			
Un 500VDC, Us 750V, Ur 150V										
PDB166*2HC30**SA	16	42.5	22	30	37.5		1.2	20	10	7.9
PDB256*2HE37**SA	25	42.5	28	37	37.5		1.2	20	12	5.5
PDB256*2HE37**SA	25	42.5	28	37	37.5	10.2	1.2	20	14	5.3
PDB356*2HF45**SA	35	42.5	30	45	37.5		1.2	20	12	4.0
PDB356*2HF45**SA	35	42.5	30	45	37.5	20.3	1.2	20	17	3.8
PDB406*2HH45**SA	40	42.5	33	45	37.5		1.2	20	12	3.6
PDB406*2HH45**SA	40	42.5	33	45	37.5	20.3	1.2	20	19	3.5
PDB456*2HS45**SA	45	57.5	30	45	52.5		1.2	13	12	5.2
PDB456*2HS45**SA	45	57.5	30	45	52.5	20.3	1.2	13	17	5.0
PDB606*2HT50**SA	60	57.5	35	50	52.5		1.2	13	12	4.4
PDB606*2HT50**SA	60	57.5	35	50	52.5	20.3	1.2	13	20	4.3
PDB806*2HU56**SA	80	57.5	42.5	56	52.5	20.3	1.2	13	22	3.7
Un 700VDC, Us 1050V, Ur 200V										
PDB156*2SC30**SA	15	42.5	22	30	37.5		1.2	21	9	8.0
PDB226*2SE37**SA	22	42.5	28	37	37.5		1.2	21	11	5.6
PDB226*2SE37**SA	22	42.5	28	37	37.5	10.2	1.2	21	11	5.4
PDB306*2SF45**SA	30	42.5	30	45	37.5		1.2	21	12	4.2
PDB306*2SF45**SA	30	42.5	30	45	37.5	20.3	1.2	21	14	4.0
PDB356*2SH45**SA	35	42.5	33	45	37.5		1.2	21	12	3.7
PDB356*2SH45**SA	35	42.5	33	45	37.5	20.3	1.2	21	16	3.6
PDB456*2SS45**SA	45	57.5	30	45	52.5		1.2	14	12	5.4
PDB456*2SS45**SA	45	57.5	30	45	52.5	20.3	1.2	14	14	5.2
PDB556*2ST50**SA	55	57.5	35	50	52.5		1.2	14	12	4.5
PDB556*2ST50**SA	55	57.5	35	50	52.5	20.3	1.2	14	17	4.4
PDB806*2SU56**SA	80	57.5	42.5	56	52.5	20.3	1.2	14	22	3.8
Un 900VDC, Us 1350V, Ur 250V										
PDB106*29C30**SA	10	42.5	22	30	37.5		1.2	30	8	9.5
PDB156*29E37**SA	15	42.5	28	37	37.5		1.2	30	11	6.5
PDB156*29E37**SA	15	42.5	28	37	37.5	10.2	1.2	30	11	6.0
PDB206*29F45**SA	20	42.5	30	45	37.5		1.2	30	12	5.0
PDB206*29F45**SA	20	42.5	30	45	37.5	20.3	1.2	30	13	4.5
PDB226*29H45**SA	22	42.5	33	45	37.5		1.2	30	12	4.6
PDB226*29H45**SA	22	42.5	33	45	37.5	20.3	1.2	30	14	4.1
PDB306*29S45**SA	30	57.5	30	45	52.5		1.2	20	12	6.4
PDB306*29S45**SA	30	57.5	30	45	52.5	20.3	1.2	20	13	5.9
PDB406*29T50**SA	40	57.5	35	50	52.5		1.2	20	12	4.9
PDB406*29T50**SA	40	57.5	35	50	52.5	20.3	1.2	20	17	4.4
PDB556*29U56**SA	55	57.5	42.5	56	52.5	20.3	1.2	20	22	3.0

規格若有任何變更將不予通知。如有產品安全或技術問題，請即與我司業務部或代理商聯繫。  
Specifications are subject to change without notice. For any concern on safety or technical aspects on the product, please contact our sales offices or agents immediately.

## 產品編碼和電性規格 PART NUMBER AND ELECTRICAL SPECIFICATIONS

產品編碼 Part Number	容量 Cap ( $\mu$ F)	尺寸 Dimension (mm)						電壓 上升 速率 du/dt (V/ $\mu$ s)	紋波 電流 I <sub>rms</sub> @25°C @10kHz (A)	等效 串聯 電阻 ESR@ 1.0kHz (m $\Omega$ )
		長度 L	寬度 B	高度 H	極距 P	引腳 距離 P1	引線 直徑 d			
Un 1100VDC, Us 1650V, Ur 300V										
PDB605*31C30**SA	6	42.5	22	30	37.5		1.2	39	7	12.9
PDB106*31E37**SA	10	42.5	28	37	37.5		1.2	39	10	8.0
PDB106*31E37**SA	10	42.5	28	37	37.5	10.2	1.2	39	10	7.5
PDB146*31F45**SA	14	42.5	30	45	37.5		1.2	39	12	5.8
PDB146*31F45**SA	14	42.5	30	45	37.5	20.3	1.2	39	12	5.3
PDB156*31H45**SA	15	42.5	33	45	37.5		1.2	39	12	5.5
PDB156*31H45**SA	15	42.5	33	45	37.5	20.3	1.2	39	13	5.0
PDB226*31S45**SA	22	57.5	30	45	52.5		1.2	26	12	7.2
PDB226*31S45**SA	22	57.5	30	45	52.5	20.3	1.2	26	13	6.7
PDB256*31T50**SA	25	57.5	35	50	52.5		1.2	26	12	6.4
PDB256*31T50**SA	25	57.5	35	50	52.5	20.3	1.2	26	14	5.9
PDB406*31U56**SA	40	57.5	42.5	56	52.5	20.3	1.2	26	20	3.7

- 備註： 產品編碼的第7位的“\*”是代表可選容差為J=  $\pm$ 5%或K=  $\pm$ 10%。  
 產品編碼的第13位的“\*”是代表可選接腳線數目為2條， 4條或6條。  
 產品編碼的第14位的“\*”是代表可選接腳線長度， E即是5mm， 3即是30mm。
- Remark : The “\*” in 7th digit is used for the capacitance tolerance, J=  $\pm$ 5% or K=  $\pm$ 10%.  
 The “\*” in 13th digit is used for the leads style, for 2 leads, 4 leads or 6 leads.  
 The “\*” in 14th digit is used for the lead length, E for 5mm, 3 for 30mm.

規格若有任何變更將不予通知。如有產品安全或技術問題，請即與我司業務部或代理商聯繫。  
 Specifications are subject to change without notice. For any concern on safety or technical aspects on the product,  
 please contact our sales offices or agents immediately.